



Tarrant
Refrigeration Ltd

Established in 1982 with over 30 years experience

Self Assembly Game Larder Construction Manual



WINNER 2006
BEST GAMEKEEPING PRODUCT

Self Assembly Game Larders and Cold Rooms created to meet your needs

The new Self Assemble Game larder is easy to install and is both highly flexible and cost effective

The floor is made from extremely hard wearing black resin with an anti-slip surface.

The walls are constructed from galvanised steel covered in a food safe coating. Insulation is provided from 85mm of high density polyurethane for exceptional insulation.

Complies with the new Food Standards Agency (FSA) Game Meat Regulations cost effectively.



Panels are joined together with cam locks.

Assembly will take on average 6 to 8 hours maximum



This is the size of a 2170 x 2170 x 2000m high game larder. Most are delivered by lorry.



EQUIPMENT

Each game larder is delivered with the following equipment.

- Allen key to do up cam locks.
- Silicone sealant
- Set of instructions
- Caps
- Additional panel seals.



PREPARE SITE

You require:

- A level floor
- Power supply
- Easy access
- Dry area

If your site is not level we recommend that you pack under the cold room floor with wood to achieve a level surface.



Lay cold floor panels on floor and pack underneath were necessary to achieve a level surface.
If more than one floor panel is being used join together using cam locks.



Leave at least 150mm gap between the wall of the building and floor panels. This is to allow room for the game larder wall panels and an air gap. Ensure floor is level.





4
Fit corner wall panels.
Please note wall panels have three cam locks, ceiling panels have more.



7
Add more panels.

8



One panel is cut ready for the refrigeration unit to straddle across. Also please note hole ready made for condensate drain.

REFRIGERATION
MOTOR

Outside Unit

Inside Unit

Light Cable

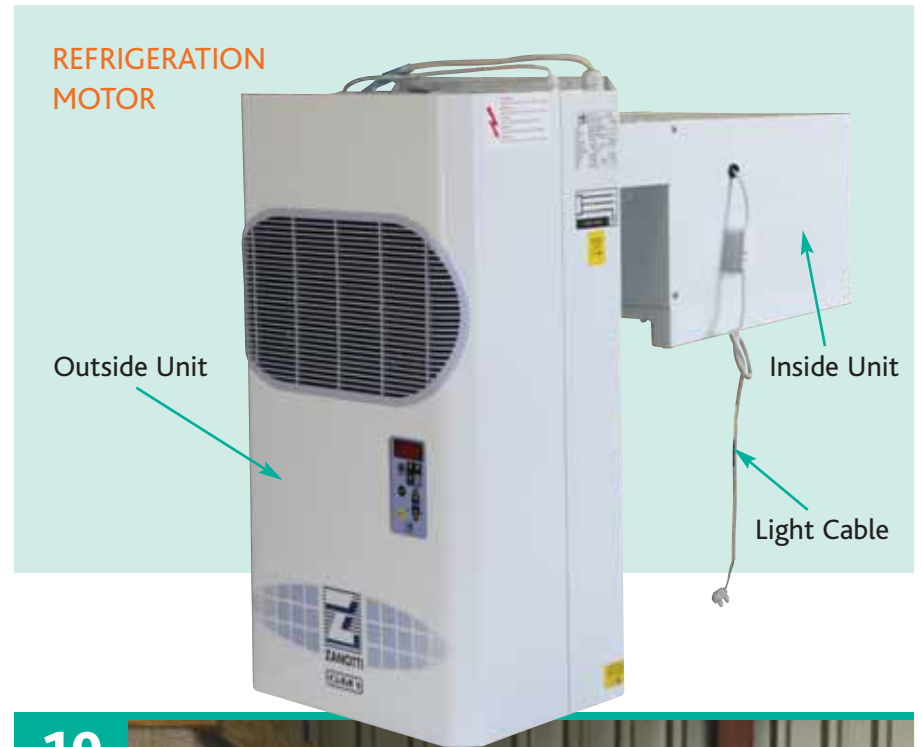

9



Rest motor on panel. Slide across until it sits in the pre-cut slots.

10



Refrigeration unit should look like this when in position.



Put back cut out parts from panel. Seal with silicone.





Fit ceiling panels.



Fit door panel.

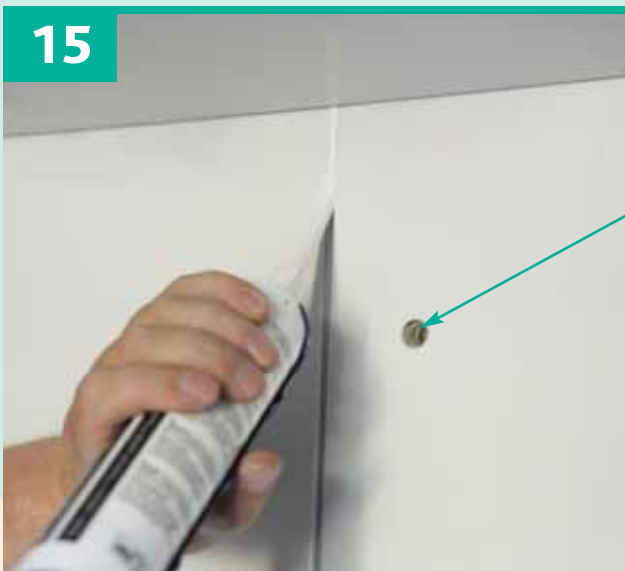

Put plastic caps in cam lock holes.

Seal up all joints in ceiling and walls (with white silicone). Then seal floor joints (with black silicone).



Plug in motor and set controls. See manual with motor. Please note that the fan motor runs continually.



Andy Tarrant, Managing Director

Whatever your enquiry please contact us:

Tarrant Refrigeration

Wagon Yard, London Road, Marlborough, Wiltshire SN8 1LH

Tel: 01672 512586 **www.gamelarder.com**

“Goes together pretty easily once you get started, the boss is very happy with the game larder.”

Danny Lyon
Gamekeeper, Kinross-shire, Scotland
assisted build

“A few friends helped me put the room up, assembled it very quickly, cooling geese at the moment, all my neighbours are coming around to look.”

Simon Gills
Farmer and Shoot Owner, Westerham, Kent

“Totally amazed by how quickly it was assembled and how quickly the room came down to temperature....a good bit of kit.”

Alexander Micklem
Walthambury, Shoot Essex